

MONTAJE DE ANTORCHA MECANIZADA

Consumibles con protección y sensado óhmico antorcha mecanizada – 105 A

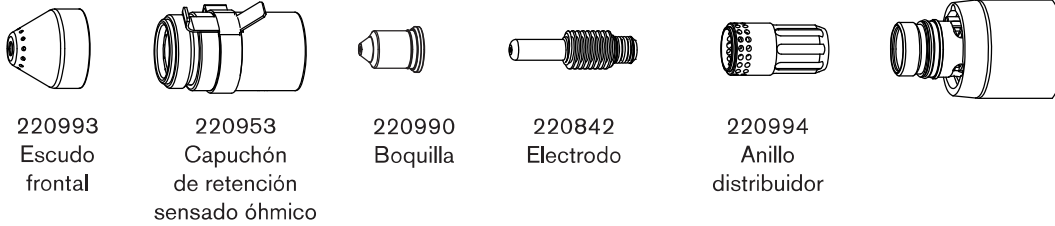

Consumibles con protección y sensado óhmico antorcha mecanizada – 45 A, 65 A, 85 A

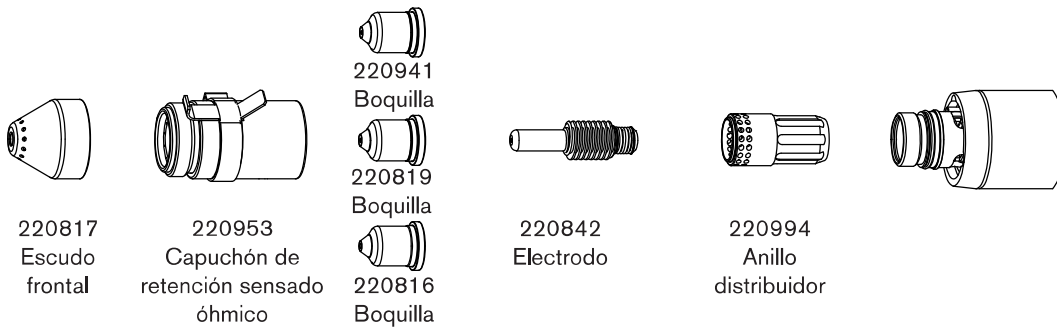

Consumibles sin protección antorcha mecanizada – 105 A

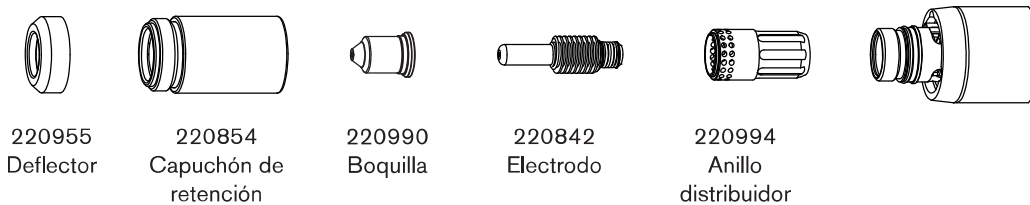

Consumibles sin protección antorcha mecanizada – 45 A, 65 A, 85 A

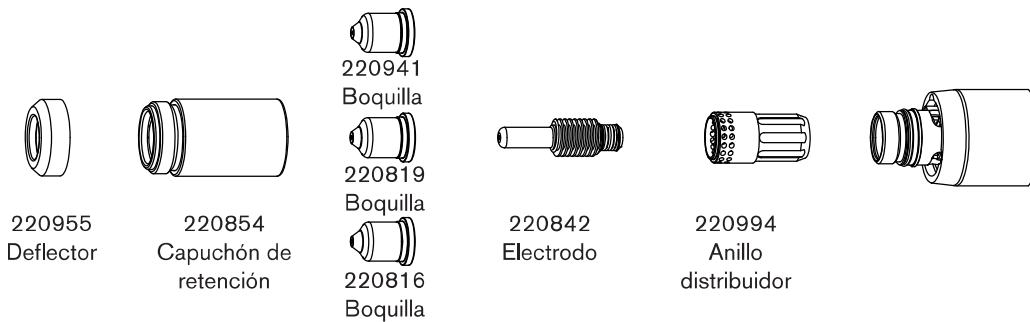

MONTAJE DE ANTORCHA MECANIZADA

Consumibles para ranurado de máxima remoción



220798
Escudo
frontal

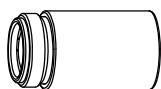

220854
Capuchón de
retención



220991
Boquilla

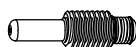

220842
Electrodo

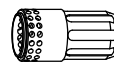

220994
Anillo
distribuidor

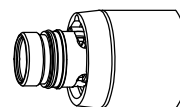

Consumibles para ranurado de máximo control



420480
Escudo
frontal

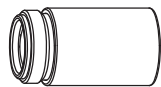

220854
Capuchón de
retención



220991
Boquilla

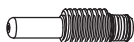

220842
Electrodo

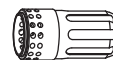

220994
Anillo
distribuidor

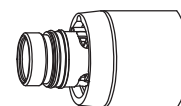

Consumibles con protección FineCut®



220948
Escudo
frontal

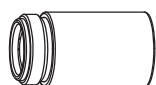

220953
Capuchón de
retención sensado
óhmico



220930
Boquilla

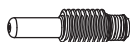

220842
Electrodo



220947
Anillo
distribuidor

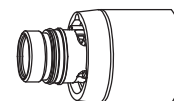

Consumibles sin protección FineCut®



220955
Deflector

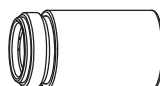

220854
Capuchón de
retención



220930
Boquilla

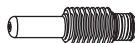

220842
Electrodo



220947
Anillo
distribuidor

